

## STORMWATER INDEX

---

|   |      |
|---|------|
| Bends – Plain – SCJ                         | 1.1  |
| Bends – Formed Bends                        | 1.2  |
| Bends – Inspection – SCJ                    | 1.3  |
| Junction – Plain – SCJ                      | 1.3  |
| Junction – Reducing Wye – SCJ               | 1.4  |
| Junction – Reducing Tee – SCJ               | 1.5  |
| Junction – Plain Inspection – SCJ           | 1.6  |
| Junction – Reducing Inspection – SCJ        | 1.6  |
| Saddles – PVC Pipe – SCJ                    | 1.7  |
| Saddles – PVC Pipe – RRJ                    | 1.8  |
| Saddles – Concrete Pipes – SCJ              | 1.10 |
| Saddles – Concrete Pipes – RRJ              | 1.12 |
| Saddles – Asbestos Cement Pipes – Wye & Tee | 1.14 |
| Saddles – Earthenware Pipes – (EW)          | 1.15 |
| Stormwater Couplings – SCJ                  | 1.16 |
| Couplings – Loose                           | 1.16 |
| Couplings – Slip                            | 1.16 |
| Stormwater Screw Cap & Base                 | 1.16 |
| Stormwater End Caps                         | 1.17 |
| Level Inverts – SCJ                         | 1.17 |
| Adaptors – Downpipe – SCJ                   | 1.18 |
| Kerb Outlets                                | 1.18 |
| Rainheads                                   | 1.19 |
| Manhole – Short – Plain – RRJ               | 1.20 |
| Manhole – Short – Gritted – RRJ             | 1.20 |

## BENDS – PLAIN – SCJ

Add G after code for Glassed - i.e: 701.150.22G

| Code          | Description          | A | B   | C   | D |
|---------------|----------------------|---|-----|-----|---|
| 701.150.11°   | Unglassed or Glassed |   | 160 | 250 |   |
| 701.150.22°   | Unglassed or Glassed |   | 160 | 250 |   |
| 701m.150.45°  | Moulded              |   | 160 | 250 |   |
| 701m.150.88°  | Moulded              |   | 160 | 245 |   |
| 701.175.11°   | Unglassed or Glassed |   | 200 | 320 |   |
| 701.175.22°   | Unglassed or Glassed |   | 200 | 320 |   |
| 701m.175.45°  | Moulded              |   | 200 | 260 |   |
| 701m.175.88°  | Moulded              |   | 200 | 305 |   |
| 701.225.11°   | Unglassed or Glassed |   | 250 | 340 |   |
| 701.225.22°   | Unglassed or Glassed |   | 250 | 340 |   |
| 701m.225.45°  | Moulded              |   | 250 | 370 |   |
| 701m.225.88°  | Moulded              |   | 250 | 410 |   |
| 701.300.11°   | Unglassed or Glassed |   | 315 | 395 |   |
| 701.300.22°   | Unglassed or Glassed |   | 315 | 395 |   |
| 701m.300.45°  | Moulded              |   | 315 | 430 |   |
| 701m.300.88°  | Moulded              |   | 315 | 480 |   |
| 701.375.11° G | Glassed              |   | 400 | 620 |   |
| 701.375.22° G | Glassed              |   | 400 | 620 |   |
| 701m.375.45°  | Moulded              |   | 400 | 580 |   |
| 701m.375.88°  | Moulded              |   | 400 | 560 |   |
| 701.475.11° G | Glassed              |   | 500 |     |   |
| 701.475.22° G | Glassed              |   | 500 |     |   |
| 701.475.45° G | Glassed              |   | 500 |     |   |
| 701.475.88° G | Glassed              |   | 500 |     |   |

Other angles available on request  
AS/NZ 1254:2010

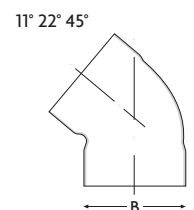

## BENDS – FORMED BENDS

Add angle at end of code - i.e: 2703.90.22°

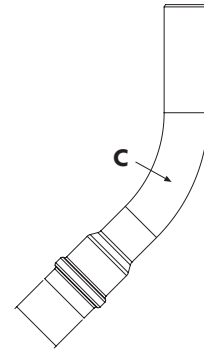

| Code        | Description     | A   | B | C   | D |
|-------------|-----------------|-----|---|-----|---|
| 2703.90.11  | 11° Formed Bend | 90  |   | 350 |   |
| 2703.90.22  | 22° Formed Bend | 90  |   | 350 |   |
| 2703.90.45  | 45° Formed Bend | 90  |   | 350 |   |
| 2703.90.90  | 90° Formed Bend | 90  |   | 350 |   |
| 2703.100.11 | 11° Formed Bend | 110 |   | 350 |   |
| 2703.100.22 | 22° Formed Bend | 110 |   | 350 |   |
| 2703.100.45 | 45° Formed Bend | 110 |   | 350 |   |
| 2703.100.90 | 90° Formed Bend | 110 |   | 400 |   |
| 2703.150.11 | 11° Formed Bend | 160 |   | 500 |   |
| 2703.150.22 | 22° Formed Bend | 160 |   | 500 |   |
| 2703.150.45 | 45° Formed Bend | 160 |   | 500 |   |
| 2703.150.90 | 90° Formed Bend | 160 |   | 500 |   |
| 2703.175.11 | 11° Formed Bend | 200 |   | 535 |   |
| 2703.175.22 | 22° Formed Bend | 200 |   | 535 |   |
| 2703.175.45 | 45° Formed Bend | 200 |   | 535 |   |
| 2703.175.90 | 90° Formed Bend | 200 |   | 535 |   |
| 2703.225.11 | 11° Formed Bend | 250 |   | 675 |   |
| 2703.225.22 | 22° Formed Bend | 250 |   | 675 |   |
| 2703.225.45 | 45° Formed Bend | 250 |   | 675 |   |
| 2703.225.90 | 90° Formed Bend | 250 |   | 675 |   |
| 2703.300.11 | 11° Formed Bend | 315 |   | 715 |   |
| 2703.300.22 | 22° Formed Bend | 315 |   | 715 |   |
| 2703.300.45 | 45° Formed Bend | 315 |   | 715 |   |
| 2703.300.90 | 90° Formed Bend | 315 |   | 715 |   |

Other sizes and radius available on request

## BENDS – INSPECTION – SCJ

Add G after code for Glassed - i.e: 703.150.88G

| Code            | Description                             | A   | B | C | D   |
|-----------------|---|-----|---|---|-----|
| 703.150.11 - 45 | c/w 100mm Hatch<br>Unglassed or Glassed | 200 |   |   | 250 |
| 703.150.88      | c/w 100mm Hatch<br>Unglassed or Glassed | 200 |   |   | 228 |
| 703.175.11 - 45 | c/w 150mm Hatch<br>Unglassed or Glassed | 245 |   |   | 320 |
| 703.175.88      | c/w 150mm Hatch<br>Unglassed or Glassed | 245 |   |   | 305 |
| 703.225.11 - 45 | c/w 150mm Hatch<br>Unglassed or Glassed | 285 |   |   | 340 |
| 703.225.88      | c/w 150mm Hatch<br>Unglassed or Glassed | 285 |   |   | 410 |
| 703.300.11 - 45 | c/w 150mm Hatch<br>Unglassed or Glassed | 377 |   |   | 395 |
| 703.300.88      | c/w 150mm Hatch<br>Unglassed or Glassed | 377 |   |   | 480 |

These are a non-stock item and therefore require manufacturing

They are also a non-returnable item

AS/NZ 1254:2010

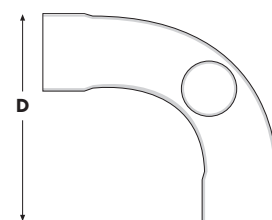
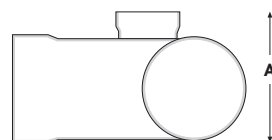

## JUNCTION – PLAIN – SCJ

| Code          | Description | A    | B | C    | D   |
|---------------|-------------|------|---|------|-----|
| 704m.175.45°  | Moulded     | 400  |   | 500  | 200 |
| 704m.225.45°  | Moulded     | 435  |   | 615  | 250 |
| 704m.300.45°  | Moulded     | 525  |   | 712  | 315 |
| 704.375.45° G | Glassed     | 750  |   | 1100 | 400 |
| 704.475.45° G | Glassed     | 1100 |   | 1250 | 500 |
| 704m.175.88°  | Moulded     | 200  |   | 380  | 200 |
| 704m.225.88°  | Moulded     | 300  |   | 520  | 250 |
| 704m.300.88°  | Moulded     | 320  |   | 600  | 315 |
| 704.375.88° G | Glassed     | 500  |   | 980  | 400 |
| 704.475.88° G | Glassed     | 600  |   | 1000 | 500 |

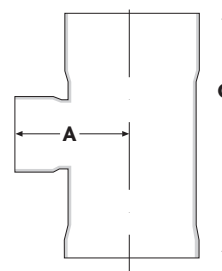
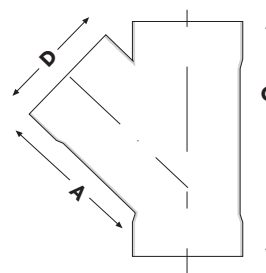

375mm and 475mm fittings are a non-stock item and are therefore made to order and non-returnable

AS/NZS 1254:2010

## JUNCTION – REDUCING WYE – SCJ

**704**

Add G after code for Glassed - i.e: 704.225.100.45G

| Code              | Description                   | A    | B   | C    | D   |
|-------------------|-------------------------------|------|-----|------|-----|
| 704.175.100.45°   | Moulded or Unglassed          | 310  | 200 | 410  | 110 |
| 704.225.100.45°   | Moulded, Unglassed or Glassed | 340  | 250 | 460  | 110 |
| 704.300.100.45°   | Unglassed or Glassed          | 400  | 315 | 480  | 110 |
| 704.375.100.45°   | Unglassed or Glassed          | 480  | 400 | 600  | 110 |
| 704.475.100.45° G | Glassed                       | 530  | 500 | 800  | 110 |
| 704.175.150.45°   | Moulded, Unglassed or Glassed | 350  | 200 | 500  | 160 |
| 704.225.150.45°   | Moulded, Unglassed or Glassed | 410  | 250 | 585  | 160 |
| 704.300.150.45°   | Unglassed or Glassed          | 470  | 315 | 600  | 160 |
| 704.375.150.45°   | Unglassed or Glassed          | 540  | 400 | 700  | 160 |
| 704.475.150.45° G | Glassed                       | 620  | 500 | 800  | 160 |
| 704.225.175.45°   | Unglassed or Glassed          | 490  | 250 | 600  | 200 |
| 704.300.175.45°   | Unglassed or Glassed          | 500  | 315 | 740  | 200 |
| 704.375.175.45°   | Unglassed or Glassed          | 620  | 400 | 750  | 200 |
| 704.475.175.45° G | Glassed                       | 650  | 500 | 800  | 200 |
| 704.300.225.45°   | Unglassed or Glassed          | 500  | 315 | 740  | 250 |
| 704.375.225.45°   | Unglassed or Glassed          | 520  | 400 | 890  | 250 |
| 704.475.225.45° G | Glassed                       | 675  | 500 | 900  | 250 |
| 704.375.300.45° G | Glassed                       | 720  | 400 | 1000 | 315 |
| 704.475.300.45° G | Glassed                       | 890  | 500 | 1000 | 315 |
| 704.475.375.45° G | Glassed                       | 1260 | 500 | 1250 | 400 |

All moulded fittings are available as Male/Female or Female/Female junctions  
 375mm and 475mm fittings are a non-stock item and are therefore made to order and non-returnable  
 AS/NZS 1254:2010

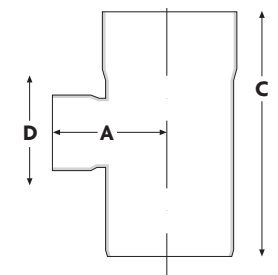
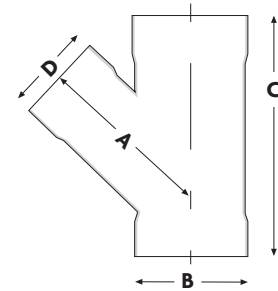

## JUNCTION – REDUCING TEE – SCJ

Add G after code for Glassed - i.e: 704.225.100.88G

| Code             | Description                   | A   | B   | C   | D   |
|------------------|-------------------------------|-----|-----|-----|-----|
| 704.150.100.88°  | Unglassed or Glassed          | 210 | 160 | 350 | 110 |
| 704.175.100.88°  | Moulded or Unglassed          | 195 | 200 | 360 | 110 |
| 704.225.100.88°  | Unglassed or Glassed          | 210 | 250 | 410 | 110 |
| 704.300.100.88°  | Unglassed or Glassed          | 250 | 315 | 450 | 110 |
| 704.375.100.88°  | Unglassed or Glassed          | 300 | 400 | 430 | 110 |
| 704.475.100.88°G | Glassed                       |     | 500 | 720 | 110 |
| 704.175.150.88°  | Moulded, Unglassed or Glassed |     | 200 |     | 160 |
| 704.225.150.88°  | Unglassed or Glassed          | 250 | 250 | 480 | 160 |
| 704.300.150.88°  | Unglassed or Glassed          | 300 | 315 | 460 | 160 |
| 704.375.150.88°  | Unglassed or Glassed          | 370 | 400 | 500 | 160 |
| 704.475.150.88°G | Glassed                       |     | 500 | 800 | 160 |
| 704.225.175.88°  | Unglassed or Glassed          | 300 | 250 | 540 | 200 |
| 704.300.175.88°  | Unglassed or Glassed          | 350 | 315 | 530 | 200 |
| 704.375.175.88°  | Unglassed or Glassed          | 400 | 400 | 520 | 200 |
| 704.475.175.88°G | Glassed                       |     | 500 | 720 | 200 |
| 704.300.225.88°  | Unglassed or Glassed          | 400 | 315 | 580 | 250 |
| 704.375.225.88°  | Unglassed or Glassed          | 400 | 400 | 570 | 250 |
| 704.475.225.88°G | Glassed                       |     | 500 | 760 | 250 |
| 704.375.300.88°G | Glassed                       |     | 400 | 650 | 315 |
| 704.475.300.88°G | Glassed                       |     | 500 | 820 | 315 |
| 704.475.375.88°G | Glassed                       |     | 500 | 930 | 400 |

All moulded fittings are available as Male/Female or Female/Female junctions  
 375mm and 475mm fittings are a non-stock item and are therefore made to order and non-returnable  
 AS/NZS 1254:2010

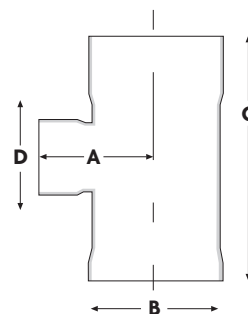

## JUNCTION – PLAIN INSPECTION – SCJ

Add G after code for Glassed - i.e: 705.150.45G

| Code           | Description                             | A   | B   | C   | D   |
|----------------|---|-----|-----|-----|-----|
| 705.150.45.100 | c/w 100mm Hatch<br>Unglassed or Glassed | 260 | 200 | 360 | 160 |
| 705.175.45.150 | c/w 150mm Hatch<br>Unglassed or Glassed | 400 | 245 | 500 | 200 |
| 705.225.45.150 | c/w 150mm Hatch<br>Unglassed or Glassed | 455 | 285 | 615 | 250 |
| 705.300.45.150 | c/w 150mm Hatch<br>Unglassed or Glassed | 600 | 377 | 712 | 315 |
| 705.150.88.100 | c/w 100mm Hatch<br>Unglassed or Glassed | 200 | 200 | 292 | 160 |
| 705.175.88.150 | c/w 150mm Hatch<br>Unglassed or Glassed | 200 | 245 | 380 | 200 |
| 705.225.88.150 | c/w 150mm Hatch<br>Unglassed or Glassed | 300 | 285 | 520 | 250 |
| 705.300.88.150 | c/w 150mm Hatch<br>Unglassed or Glassed | 300 | 377 | 600 | 315 |

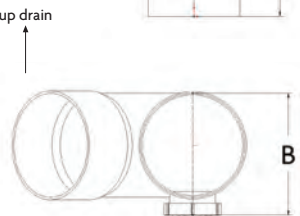
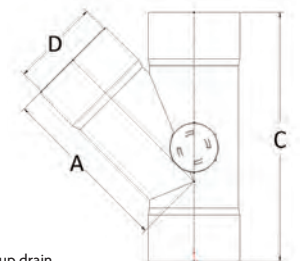
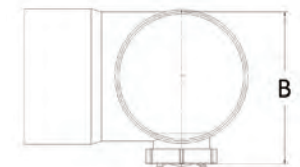
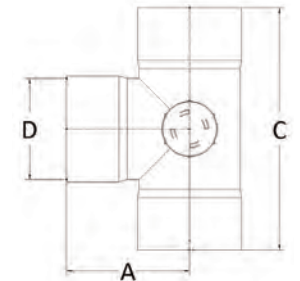

## JUNCTION – REDUCING INSPECTION – SCJ

Add G after code for Glassed - i.e: 705.150.45G

| Code           | Description                             | A   | B   | C   | D   |
|----------------|---|-----|-----|-----|-----|
| 705.150.100.45 | c/w 100mm Hatch<br>Unglassed or Glassed | 220 | 160 | 380 | 110 |
| 705.150.100.88 | c/w 150mm Hatch<br>Unglassed or Glassed | 220 | 160 | 380 | 110 |
| 705.150.100.45 | c/w 150mm Hatch<br>Unglassed or Glassed | 175 | 160 | 300 | 110 |
| 705.150.100.88 | c/w 150mm Hatch<br>Unglassed or Glassed | 175 | 160 | 300 | 110 |
| 705.150.100.45 | c/w 150mm Hatch<br>Unglassed or Glassed | 300 | 200 | 355 | 110 |
| 705.150.100.88 | c/w 100mm Hatch<br>Unglassed or Glassed | 210 | 200 | 410 | 110 |
| 705.150.100.45 | c/w 150mm Hatch<br>Unglassed or Glassed | 300 | 200 | 410 | 110 |
| 705.150.100.88 | c/w 150mm Hatch<br>Unglassed or Glassed | 210 | 200 | 410 | 110 |

These fittings are a non-stock item and therefore require manufacturing and are therefore a non-returnable item

## SADDLES – PVC PIPE – SCJ

### 45° Unglassed

| Code                  | Description   | A   | B | C   | D |
|-----------------------|---------------|-----|---|-----|---|
| 704s.150 PVC / 100.45 | Unglassed 45° | 250 |   | 300 |   |
| 704s.175 PVC / 100.45 | Unglassed 45° | 250 |   | 300 |   |
| 704s.225 PVC / 100.45 | Unglassed 45° | 250 |   | 300 |   |
| 704s.300 PVC / 100.45 | Unglassed 45° | 250 |   | 300 |   |
| 704s.375 PVC / 100.45 | Unglassed 45° | 250 |   | 300 |   |
| 704s.475 PVC / 100.45 | Unglassed 45° | 250 |   | 300 |   |
| 704s.175 PVC / 150.45 | Unglassed 45° | 350 |   | 400 |   |
| 704s.225 PVC / 150.45 | Unglassed 45° | 350 |   | 400 |   |
| 704s.300 PVC / 150.45 | Unglassed 45° | 400 |   | 400 |   |
| 704s.375 PVC / 150.45 | Unglassed 45° | 480 |   | 400 |   |
| 704s.475 PVC / 150.45 | Unglassed 45° | 480 |   | 400 |   |
| 704s.225 PVC / 175.45 | Unglassed 45° | 450 |   | 500 |   |
| 704s.300 PVC / 175.45 | Unglassed 45° | 440 |   | 500 |   |
| 704s.375 PVC / 175.45 | Unglassed 45° | 600 |   | 500 |   |
| 704s.475 PVC / 175.45 | Unglassed 45° | 600 |   | 500 |   |

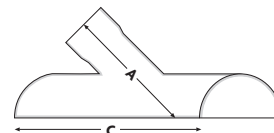

### 88° Unglassed

| Code                  | Description   | A   | B | C   | D |
|-----------------------|---------------|-----|---|-----|---|
| 704s.150 PVC / 100.88 | Unglassed 88° | 150 |   | 250 |   |
| 704s.175 PVC / 100.88 | Unglassed 88° | 150 |   | 250 |   |
| 704s.225 PVC / 100.88 | Unglassed 88° | 150 |   | 250 |   |
| 704s.300 PVC / 100.88 | Unglassed 88° | 150 |   | 250 |   |
| 704s.375 PVC / 100.88 | Unglassed 88° | 150 |   | 250 |   |
| 704s.475 PVC / 100.88 | Unglassed 88° | 150 |   | 250 |   |
| 704s.175 PVC / 150.88 | Unglassed 88° | 210 |   | 350 |   |
| 704s.225 PVC / 150.88 | Unglassed 88° | 210 |   | 350 |   |
| 704s.300 PVC / 150.88 | Unglassed 88° | 210 |   | 350 |   |
| 704s.375 PVC / 150.88 | Unglassed 88° | 210 |   | 350 |   |
| 704s.475 PVC / 150.88 | Unglassed 88° | 210 |   | 350 |   |
| 704s.225 PVC / 175.88 | Unglassed 88° | 310 |   | 400 |   |
| 704s.300 PVC / 175.88 | Unglassed 88° | 310 |   | 400 |   |
| 704s.375 PVC / 175.88 | Unglassed 88° | 310 |   | 400 |   |
| 704s.475 PVC / 175.88 | Unglassed 88° | 310 |   | 400 |   |

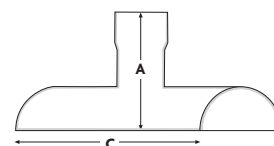

Some fittings are a non-stock item and are therefore made to order and non-returnable  
AS/NZS 1254:2010



## SADDLES – PVC PIPE – RRJ

### 45° Glassed

| Code                           | Description | A   | B | C   | D |
|--------------------------------|-------------|-----|---|-----|---|
| <b>Z704s.150 PVC / 100.45G</b> | Glassed 45° | 320 |   | 300 |   |
| <b>Z704s.175 PVC / 100.45G</b> | Glassed 45° | 320 |   | 300 |   |
| <b>Z704s.225 PVC / 100.45G</b> | Glassed 45° | 350 |   | 300 |   |
| <b>Z704s.300 PVC / 100.45G</b> | Glassed 45° | 350 |   | 300 |   |
| <b>Z704s.375 PVC / 100.45G</b> | Glassed 45° | 400 |   | 300 |   |
| <b>Z704s.475 PVC / 100.45G</b> | Glassed 45° | 400 |   | 400 |   |
| <b>Z704s.175 PVC / 150.45G</b> | Glassed 45° | 430 |   | 400 |   |
| <b>Z704s.225 PVC / 150.45G</b> | Glassed 45° | 450 |   | 400 |   |
| <b>Z704s.300 PVC / 150.45G</b> | Glassed 45° | 500 |   | 400 |   |
| <b>Z704s.375 PVC / 150.45G</b> | Glassed 45° | 650 |   | 400 |   |
| <b>Z704s.475 PVC / 150.45G</b> | Glassed 45° | 700 |   | 400 |   |
| <b>Z704s.225 PVC / 175.45G</b> | Glassed 45° | 450 |   | 500 |   |
| <b>Z704s.300 PVC / 175.45G</b> | Glassed 45° | 600 |   | 500 |   |
| <b>Z704s.375 PVC / 175.45G</b> | Glassed 45° | 650 |   | 500 |   |
| <b>Z704s.475 PVC / 175.45G</b> | Glassed 45° | 750 |   | 500 |   |
| <b>Z704s.300 PVC / 225.45G</b> | Glassed 45° |     |   | 600 |   |
| <b>Z704s.375 PVC / 225.45G</b> | Glassed 45° |     |   | 600 |   |
| <b>Z704s.475 PVC / 225.45G</b> | Glassed 45° |     |   | 600 |   |
| <b>Z704s.375 PVC / 300.45G</b> | Glassed 45° |     |   | 750 |   |
| <b>Z704s.475 PVC / 300.45G</b> | Glassed 45° |     |   | 800 |   |

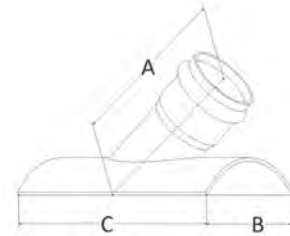

Some fittings are a non-stock item and are therefore made to order and non-returnable  
AS/NZS 1254:2010

**88° Glassed**

| Code                           | Description | A   | B | C   | D |
|--------------------------------|-------------|-----|---|-----|---|
| <b>Z704s.150 PVC / 100.88G</b> | Glassed 88° | 215 |   | 250 |   |
| <b>Z704s.175 PVC / 100.88G</b> | Glassed 88° | 215 |   | 250 |   |
| <b>Z704s.225 PVC / 100.88G</b> | Glassed 88° | 230 |   | 250 |   |
| <b>Z704s.300 PVC / 100.88G</b> | Glassed 88° | 240 |   | 250 |   |
| <b>Z704s.375 PVC / 100.88G</b> | Glassed 88° | 250 |   | 250 |   |
| <b>Z704s.475 PVC / 100.88G</b> | Glassed 88° | 250 |   | 250 |   |
| <b>Z704s.175 PVC / 150.88G</b> | Glassed 88° | 310 |   | 350 |   |
| <b>Z704s.225 PVC / 150.88G</b> | Glassed 88° | 310 |   | 350 |   |
| <b>Z704s.300 PVC / 150.88G</b> | Glassed 88° | 315 |   | 350 |   |
| <b>Z704s.375 PVC / 150.88G</b> | Glassed 88° | 315 |   | 350 |   |
| <b>Z704s.475 PVC / 150.88G</b> | Glassed 88° | 315 |   | 350 |   |
| <b>Z704s.225 PVC / 175.88G</b> | Glassed 88° | 400 |   | 400 |   |
| <b>Z704s.300 PVC / 175.88G</b> | Glassed 88° | 400 |   | 400 |   |
| <b>Z704s.375 PVC / 175.88G</b> | Glassed 88° | 400 |   | 400 |   |
| <b>Z704s.475 PVC / 175.88G</b> | Glassed 88° | 400 |   | 400 |   |
| <b>Z704s.300 PVC / 225.88G</b> | Glassed 88° | 450 |   | 500 |   |
| <b>Z704s.375 PVC / 225.88G</b> | Glassed 88° | 450 |   | 500 |   |
| <b>Z704s.475 PVC / 225.88G</b> | Glassed 88° | 450 |   | 500 |   |
| <b>Z704s.375 PVC / 300.88G</b> | Glassed 88° | 500 |   | 600 |   |
| <b>Z704s.475 PVC / 300.88G</b> | Glassed 88° | 500 |   | 600 |   |

Some fittings are a non-stock item and are therefore made to order and non-returnable  
AS/NZS 1254:2010

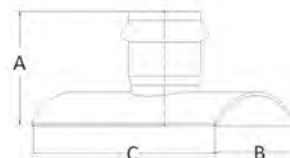
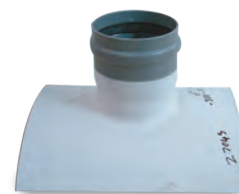

## SADDLES – CONCRETE PIPES – SCJ

Add G after code for Glassed - i.e: 704s.225conc / 100.45G

| Code                   | Description          | A   | B    | C   | D |
|------------------------|----------------------|-----|------|-----|---|
| 704s.225.conc / 100.45 | Unglassed or Glassed | 220 | 293  | 300 |   |
| 704s.225.conc / 150.45 | Unglassed or Glassed | 480 | 293  | 400 |   |
| 704s.225.conc / 175.45 | Unglassed or Glassed |     | 293  | 500 |   |
| 704s.300.conc / 100.45 | Unglassed or Glassed | 320 | 363  | 300 |   |
| 704s.300.conc / 150.45 | Unglassed or Glassed | 300 | 363  | 400 |   |
| 704s.300.conc / 175.45 | Unglassed or Glassed |     | 363  | 500 |   |
| 704s.375.conc / 100.45 | Unglassed or Glassed | 280 | 445  | 300 |   |
| 704s.375.conc / 150.45 | Unglassed or Glassed |     | 445  | 400 |   |
| 704s.375.conc / 175.45 | Unglassed or Glassed |     | 445  | 500 |   |
| 704s.450.conc / 100.45 | Unglassed or Glassed | 250 | 533  | 300 |   |
| 704s.450.conc / 150.45 | Unglassed or Glassed | 250 | 533  | 400 |   |
| 704s.450.conc / 175.45 | Unglassed or Glassed |     | 533  | 500 |   |
| 704s.525.conc / 100.45 | Unglassed or Glassed | 250 | 615  | 300 |   |
| 704s.525.conc / 150.45 | Unglassed or Glassed |     | 615  | 400 |   |
| 704s.525.conc / 175.45 | Unglassed or Glassed |     | 615  | 500 |   |
| 704s.600.conc / 100.45 | Unglassed or Glassed | 250 | 698  | 300 |   |
| 704s.600.conc / 150.45 | Unglassed or Glassed |     | 698  | 400 |   |
| 704s.600.conc / 175.45 | Unglassed or Glassed |     | 698  | 500 |   |
| 704s.675.conc / 100.45 | Unglassed or Glassed | 250 | 782  | 300 |   |
| 704s.675.conc / 150.45 | Unglassed or Glassed |     | 782  | 400 |   |
| 704s.675.conc / 175.45 | Unglassed or Glassed |     | 782  | 500 |   |
| 704s.750.conc / 100.45 | Unglassed or Glassed | 250 | 864  | 300 |   |
| 704s.750.conc / 150.45 | Unglassed or Glassed |     | 864  | 400 |   |
| 704s.750.conc / 175.45 | Unglassed or Glassed |     | 864  | 500 |   |
| 704s.825.conc / 100.45 | Unglassed or Glassed | 250 | 944  | 300 |   |
| 704s.825.conc / 150.45 | Unglassed or Glassed | 350 | 944  | 400 |   |
| 704s.825.conc / 175.45 | Unglassed or Glassed |     | 944  | 500 |   |
| 704s.900.conc / 100.45 | Unglassed or Glassed |     | 1039 | 300 |   |
| 704s.900.conc / 150.45 | Unglassed or Glassed |     | 1039 | 400 |   |
| 704s.900.conc / 175.45 | Unglassed or Glassed |     | 1039 | 500 |   |

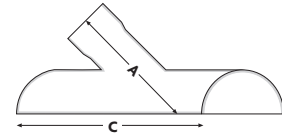

Some fittings are a non-stock item and are therefore made to order and non-returnable  
AS/NZS 1254:2010

## SADDLES – CONCRETE PIPES – SCJ

Add G after code for Glassed - i.e: 704s.225.conc / 100.88G

| Code                     | Description          | A   | B    | C   | D |
|--------------------------|----------------------|-----|------|-----|---|
| 704s.225.conc / 100.88°  | Unglassed or Glassed | 155 | 293  | 250 |   |
| 704s.225.conc / 150.88°  | Unglassed or Glassed | 195 | 293  | 350 |   |
| 704s.225.conc / 175.88°  | Unglassed or Glassed |     | 293  | 400 |   |
| 704s.300.conc / 100.88°  | Unglassed or Glassed |     | 363  | 250 |   |
| 704s.300.conc / 150.88°  | Unglassed or Glassed | 235 | 363  | 350 |   |
| 704s.300.conc / 175.88°  | Unglassed or Glassed |     | 363  | 400 |   |
| 704s.375.conc / 100.88°  | Unglassed or Glassed |     | 445  | 250 |   |
| 704s.375.conc / 150.88°  | Unglassed or Glassed |     | 445  | 350 |   |
| 704s.375.conc / 175.88°  | Unglassed or Glassed |     | 445  | 400 |   |
| 704s.450.conc / 100.88°  | Unglassed or Glassed |     | 533  | 250 |   |
| 704s.450.conc / 150.88°  | Unglassed or Glassed |     | 533  | 350 |   |
| 704s.450.conc / 175.88°  | Unglassed or Glassed |     | 533  | 400 |   |
| 704s.525.conc / 100.88°  | Unglassed or Glassed |     | 615  | 250 |   |
| 704s.525.conc / 150.88°  | Unglassed or Glassed |     | 615  | 350 |   |
| 704s.525.conc / 175.88°  | Unglassed or Glassed |     | 615  | 400 |   |
| 704s.600.conc / 100.88°  | Unglassed or Glassed |     | 698  | 250 |   |
| 704st.600.conc / 150.88° | Unglassed or Glassed |     | 698  | 350 |   |
| 704s.600.conc / 175.88°  | Unglassed or Glassed |     | 698  | 400 |   |
| 704s.675.conc / 100.88°  | Unglassed or Glassed |     | 782  | 250 |   |
| 704s.675.conc / 150.88°  | Unglassed or Glassed |     | 782  | 350 |   |
| 704s.675.conc / 175.88°  | Unglassed or Glassed |     | 782  | 400 |   |
| 704s.750.conc / 100.88°  | Unglassed or Glassed |     | 864  | 250 |   |
| 704s.750.conc / 150.88°  | Unglassed or Glassed |     | 864  | 350 |   |
| 704s.750.conc / 175.88°  | Unglassed or Glassed |     | 864  | 400 |   |
| 704s.825.conc / 100.88°  | Unglassed or Glassed |     | 944  | 250 |   |
| 704s.825.conc / 150.88°  | Unglassed or Glassed |     | 944  | 350 |   |
| 704s.825.conc / 175.88°  | Unglassed or Glassed |     | 944  | 400 |   |
| 704s.900.conc / 100.88°  | Unglassed or Glassed |     | 1039 | 250 |   |
| 704s.900.conc / 150.88°  | Unglassed or Glassed |     | 1039 | 350 |   |
| 704s.900.conc / 175.88°  | Unglassed or Glassed |     | 1039 | 400 |   |

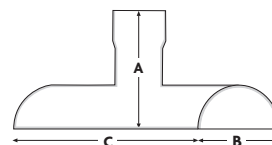

Some fittings are a non-stock item and are therefore made to order and non-returnable  
AS/NZS 1254:2010

## SADDLES – CONCRETE PIPES – RRJ

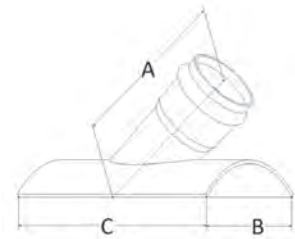

| Code                            | Description | A   | B    | C   | D |
|---------------------------------|-------------|-----|------|-----|---|
| <b>Z704s.225.conc / 100.45G</b> | Glassed 45° | 250 | 293  | 300 |   |
| <b>Z704s.225.conc / 150.45G</b> | Glassed 45° |     | 293  | 400 |   |
| <b>Z704s.225.conc / 175.45G</b> | Glassed 45° |     | 293  | 500 |   |
| <b>Z704s.300.conc / 100.45G</b> | Glassed 45° | 270 | 363  | 300 |   |
| <b>Z704s.300.conc / 150.45G</b> | Glassed 45° | 400 | 363  | 400 |   |
| <b>Z704s.300.conc / 175.45G</b> | Glassed 45° |     | 363  | 500 |   |
| <b>Z704s.375.conc / 100.45G</b> | Glassed 45° | 220 | 445  | 300 |   |
| <b>Z704s.375.conc / 150.45G</b> | Glassed 45° |     | 445  | 400 |   |
| <b>Z704s.375.conc / 175.45G</b> | Glassed 45° |     | 445  | 500 |   |
| <b>Z704s.450.conc / 100.45G</b> | Glassed 45° | 220 | 533  | 300 |   |
| <b>Z704s.450.conc / 150.45G</b> | Glassed 45° |     | 533  | 400 |   |
| <b>Z704s.450.conc / 175.45G</b> | Glassed 45° |     | 533  | 500 |   |
| <b>Z704s.525.conc / 100.45G</b> | Glassed 45° | 220 | 615  | 300 |   |
| <b>Z704s.525.conc / 150.45G</b> | Glassed 45° |     | 615  | 400 |   |
| <b>Z704s.525.conc / 175.45G</b> | Glassed 45° |     | 615  | 500 |   |
| <b>Z704s.600.conc / 100.45G</b> | Glassed 45° | 200 | 698  | 300 |   |
| <b>Z704s.600.conc / 150.45G</b> | Glassed 45° |     | 698  | 400 |   |
| <b>Z704s.600.conc / 175.45G</b> | Glassed 45° |     | 698  | 500 |   |
| <b>Z704s.675.conc / 100.45G</b> | Glassed 45° | 190 | 782  | 300 |   |
| <b>Z704s.675.conc / 150.45G</b> | Glassed 45° |     | 782  | 400 |   |
| <b>Z704s.675.conc / 175.45G</b> | Glassed 45° |     | 782  | 500 |   |
| <b>Z704s.750.conc / 100.45G</b> | Glassed 45° | 150 | 864  | 300 |   |
| <b>Z704s.750.conc / 150.45G</b> | Glassed 45° |     | 864  | 400 |   |
| <b>Z704s.750.conc / 175.45G</b> | Glassed 45° |     | 864  | 500 |   |
| <b>Z704s.825.conc / 100.45G</b> | Glassed 45° | 300 | 944  | 300 |   |
| <b>Z704s.825.conc / 150.45G</b> | Glassed 45° |     | 944  | 400 |   |
| <b>Z704s.825.conc / 175.45G</b> | Glassed 45° |     | 944  | 500 |   |
| <b>Z704s.900.conc / 100.45G</b> | Glassed 45° |     | 1039 | 300 |   |
| <b>Z704s.900.conc / 150.45G</b> | Glassed 45° |     | 1039 | 400 |   |
| <b>Z704s.900.conc / 175.45G</b> | Glassed 45° |     | 1039 | 500 |   |

Some fittings are a non-stock item and are therefore made to order and non-returnable

AS/NZS 1254:2010

| Code                            | Description | A   | B    | C   | D |
|---------------------------------|-------------|-----|------|-----|---|
| <b>Z704s.225.conc / 100.88G</b> | Glassed 88° | 155 | 293  | 250 |   |
| <b>Z704s.225.conc / 150.88G</b> | Glassed 88° | 195 | 293  | 350 |   |
| <b>Z704s.225.conc / 175.88G</b> | Glassed 88° |     | 293  | 400 |   |
| <b>Z704s.300.conc / 100.88G</b> | Glassed 88° |     | 363  | 250 |   |
| <b>Z704s.300.conc / 150.88G</b> | Glassed 88° | 330 | 363  | 350 |   |
| <b>Z704s.300.conc / 175.88G</b> | Glassed 88° |     | 363  | 400 |   |
| <b>Z704s.375.conc / 100.88G</b> | Glassed 88° |     | 445  | 250 |   |
| <b>Z704s.375.conc / 150.88G</b> | Glassed 88° |     | 445  | 350 |   |
| <b>Z704s.375.conc / 175.88G</b> | Glassed 88° |     | 445  | 400 |   |
| <b>Z704s.450.conc / 100.88G</b> | Glassed 88° |     | 533  | 250 |   |
| <b>Z704s.450.conc / 150.88G</b> | Glassed 88° |     | 533  | 350 |   |
| <b>Z704s.450.conc / 175.88G</b> | Glassed 88° |     | 533  | 400 |   |
| <b>Z704s.525.conc / 100.88G</b> | Glassed 88° |     | 615  | 250 |   |
| <b>Z704s.525.conc / 150.88G</b> | Glassed 88° |     | 615  | 350 |   |
| <b>Z704s.525.conc / 175.88G</b> | Glassed 88° |     | 615  | 400 |   |
| <b>Z704s.600.conc / 100.88G</b> | Glassed 88° |     | 698  | 250 |   |
| <b>Z704s.600.conc / 150.88G</b> | Glassed 88° |     | 698  | 350 |   |
| <b>Z704s.600.conc / 175.88G</b> | Glassed 88° |     | 698  | 400 |   |
| <b>Z704s.675.conc / 100.88G</b> | Glassed 88° |     | 782  | 250 |   |
| <b>Z704s.675.conc / 150.88G</b> | Glassed 88° |     | 782  | 350 |   |
| <b>Z704s.675.conc / 175.88G</b> | Glassed 88° |     | 782  | 400 |   |
| <b>Z704s.750.conc / 100.88G</b> | Glassed 88° |     | 864  | 250 |   |
| <b>Z704s.750.conc / 150.88G</b> | Glassed 88° |     | 864  | 350 |   |
| <b>Z704s.750.conc / 175.88G</b> | Glassed 88° |     | 864  | 400 |   |
| <b>Z704s.825.conc / 100.88G</b> | Glassed 88° |     | 944  | 250 |   |
| <b>Z704s.825.conc / 150.88G</b> | Glassed 88° |     | 944  | 350 |   |
| <b>Z704s.825.conc / 175.88G</b> | Glassed 88° |     | 944  | 400 |   |
| <b>Z704s.900.conc / 100.88G</b> | Glassed 88° |     | 1039 | 250 |   |
| <b>Z704s.900.conc / 150.88G</b> | Glassed 88° |     | 1039 | 350 |   |
| <b>Z704s.900.conc / 175.88G</b> | Glassed 88° |     | 1039 | 400 |   |

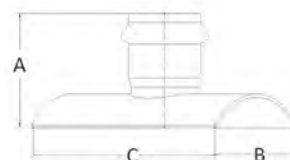
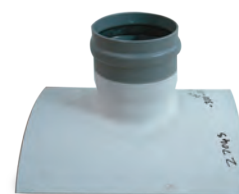

Some fittings are a non-stock item and are therefore made to order and non-returnable

AS/NZS 1254:2010

## SADDLES – ASBESTOS CEMENT PIPES – WYE & TEE

### SADDLES – SCJ

Add G after code for Glassed - i.e: 704s.150.A.C / 100.45G

| Code                  | Description              | A   | B   | C   | D |
|-----------------------|--------------------------|-----|-----|-----|---|
| 704s.100.A.C / 100.45 | SCJ Unglassed or Glassed |     | 120 |     |   |
| 704s.150.A.C / 100.45 | SCJ Unglassed or Glassed | 250 | 177 | 300 |   |
| 704s.150.A.C / 150.45 | SCJ Unglassed or Glassed | 400 | 177 | 400 |   |
| 704s.200.A.C / 100.45 | SCJ Unglassed or Glassed | 250 | 235 | 300 |   |
| 704s.200.A.C / 150.45 | SCJ Unglassed or Glassed | 300 | 235 | 400 |   |
| 704s.100.A.C / 100.88 | SCJ Unglassed or Glassed |     | 120 |     |   |
| 704s.150.A.C / 100.88 | SCJ Unglassed or Glassed |     | 177 |     |   |
| 704s.150.A.C / 150.88 | SCJ Unglassed or Glassed |     | 177 |     |   |
| 704s.200.A.C / 100.88 | SCJ Unglassed or Glassed |     | 235 |     |   |
| 704s.200.A.C / 150.88 | SCJ Unglassed or Glassed |     | 235 |     |   |

AS/NZ 1254:2010

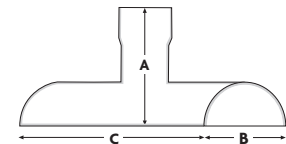
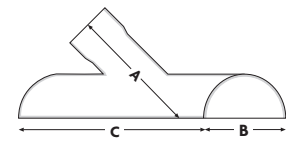

### SADDLES – RRJ

Add G after code for Glassed - i.e: Z704s.150.A.C / 100.45G

| Code                   | Description              | A   | B   | C   | D |
|------------------------|--------------------------|-----|-----|-----|---|
| Z704s.100.A.C / 100.45 | RRJ Unglassed or Glassed | 300 | 120 | 300 |   |
| Z704s.150.A.C / 100.45 | RRJ Unglassed or Glassed | 300 | 177 | 300 |   |
| Z704s.150.A.C / 150.45 | RRJ Unglassed or Glassed | 450 | 177 | 400 |   |
| Z704s.200.A.C / 100.45 | RRJ Unglassed or Glassed | 300 | 235 | 300 |   |
| Z704s.200.A.C / 150.45 | RRJ Unglassed or Glassed | 450 | 235 | 400 |   |
| Z704s.100.A.C / 100.88 | RRJ Unglassed or Glassed |     | 120 |     |   |
| Z704s.150.A.C / 100.88 | RRJ Unglassed or Glassed | 220 | 177 | 250 |   |
| Z704s.150.A.C / 150.88 | RRJ Unglassed or Glassed |     | 177 |     |   |
| Z704s.200.A.C / 100.88 | RRJ Unglassed or Glassed |     | 235 |     |   |
| Z704s.200.A.C / 150.88 | RRJ Unglassed or Glassed |     | 235 |     |   |

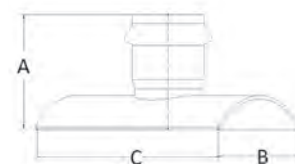
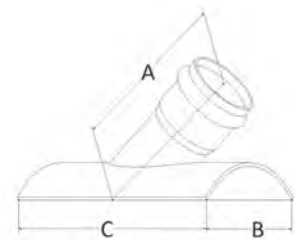
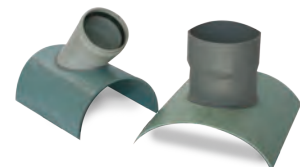

Some fittings are a non-stock item and are therefore made to order and non-returnable

AS/NZ 1254:2010



## SADDLES – EARTHENWARE PIPES – (EW)

### SADDLES – SCJ

Add G after code for Glassed - i.e: 704s.100.E.W / 100.45G

| Code                   | Description              | A | B   | C | D |
|------------------------|--------------------------|---|-----|---|---|
| 704s.100.E.W / 100.45  | SCJ Unglassed or Glassed |   | 138 |   |   |
| 704s.150.E.W / 100 .45 | SCJ Unglassed or Glassed |   | 194 |   |   |
| 704s.225.E.W / 100 .45 | SCJ Unglassed or Glassed |   | 280 |   |   |
| 704s.225.E.W / 150 .45 | SCJ Unglassed or Glassed |   | 280 |   |   |
| 704s.300.E.W / 100 .45 | SCJ Unglassed or Glassed |   | 370 |   |   |
| 704s.300.E.W / 150 .45 | SCJ Unglassed or Glassed |   | 370 |   |   |
| 704s.100.E.W / 100.88  | SCJ Unglassed or Glassed |   | 138 |   |   |
| 704s.150.E.W / 100 .88 | SCJ Unglassed or Glassed |   | 194 |   |   |
| 704s.225.E.W / 100 .88 | SCJ Unglassed or Glassed |   | 280 |   |   |
| 704s.225.E.W / 150 .88 | SCJ Unglassed or Glassed |   | 280 |   |   |
| 704s.300.E.W / 100 .88 | SCJ Unglassed or Glassed |   | 370 |   |   |
| 704s.300.E.W / 150 .88 | SCJ Unglassed or Glassed |   | 370 |   |   |

AS/NZS 125x4:2010

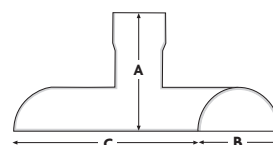
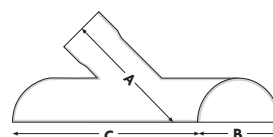

### SADDLES – RRJ

Add G after code for Glassed - i.e: Z704s.100.E.W / 100.45G

| Code                    | Description              | A | B   | C | D |
|-------------------------|--------------------------|---|-----|---|---|
| Z704s.100.E.W / 100.45  | RRJ Unglassed or Glassed |   | 138 |   |   |
| Z704s.150.E.W / 100 .45 | RRJ Unglassed or Glassed |   | 194 |   |   |
| Z704s.225.E.W / 100 .45 | RRJ Unglassed or Glassed |   | 280 |   |   |
| Z704s.225.E.W / 150 .45 | RRJ Unglassed or Glassed |   | 280 |   |   |
| Z704s.300.E.W / 100 .45 | RRJ Unglassed or Glassed |   | 370 |   |   |
| Z704s.300.E.W / 150 .45 | RRJ Unglassed or Glassed |   | 370 |   |   |
| Z704s.100.E.W / 100.88  | RRJ Unglassed or Glassed |   | 138 |   |   |
| Z704s.150.E.W / 100 .88 | RRJ Unglassed or Glassed |   | 194 |   |   |
| Z704s.225.E.W / 100 .88 | RRJ Unglassed or Glassed |   | 280 |   |   |
| Z704s.225.E.W / 150 .88 | RRJ Unglassed or Glassed |   | 280 |   |   |
| Z704s.300.E.W / 100 .88 | RRJ Unglassed or Glassed |   | 370 |   |   |
| Z704s.300.E.W / 150 .88 | RRJ Unglassed or Glassed |   | 370 |   |   |

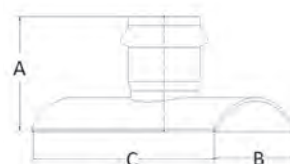
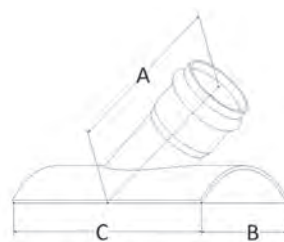
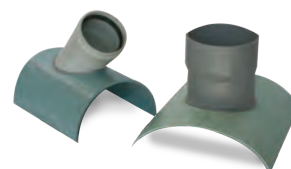

Some fittings are a non-stock item and are therefore made to order and non-returnable

AS/NZS 1254:2010



## STORMWATER COUPLINGS – SCJ

### COUPLINGS – LOOSE

| Code       | Description | A | B   | C   | D |
|------------|-------------|---|-----|-----|---|
| 710m.L.150 | Moulded     |   | 160 | 180 |   |
| 710m.L.175 | Moulded     |   | 200 | 224 |   |
| 710m.L.225 | Moulded     |   | 250 | 263 |   |
| 710m.L.300 | Moulded     |   | 315 | 308 |   |
| 710m.L.375 | Moulded     |   | 400 | 345 |   |
| 710m.L.475 | Fabricated  |   | 500 | 530 |   |

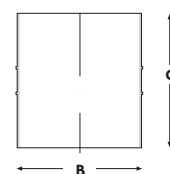

### COUPLINGS – SLIP

| Code       | Description | A | B   | C   | D |
|------------|-------------|---|-----|-----|---|
| 710m.S.150 | Moulded     |   | 160 | 180 |   |
| 710m.S.175 | Moulded     |   | 200 | 224 |   |
| 710m.S.225 | Moulded     |   | 250 | 263 |   |
| 710m.S.300 | Moulded     |   | 315 | 308 |   |
| 710m.S.375 | Moulded     |   | 400 | 345 |   |

## STORMWATER SCREW CAP & BASE

| Code     | Description          | A   | B   | C | D |
|----------|----------------------|-----|-----|---|---|
| 736m.175 | Moulded – Spigot End | 111 | 200 |   |   |
| 736m.225 | Moulded – Spigot End | 96  | 250 |   |   |
| 736m.300 | Moulded – Spigot End | 362 | 315 |   |   |

AS/NZS 1254:2010

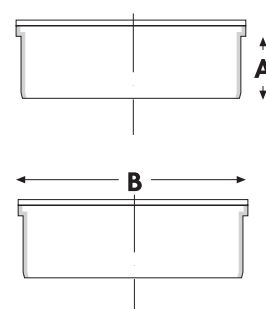

## STORMWATER END CAPS

| Code     | Description          | A   | B   | C | D |
|----------|----------------------|-----|-----|---|---|
| 737m.175 | Moulded              | 40  | 200 |   |   |
| 737m.225 | Moulded              | 40  | 250 |   |   |
| 737m.300 | Moulded              | 50  | 315 |   |   |
| 737m.375 | Moulded              | 100 | 400 |   |   |
| 737.475  | Unglassed or Pressed | 260 | 500 |   |   |
| 737.475G | Glassed              | 260 | 500 |   |   |

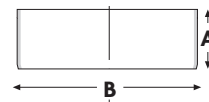

## LEVEL INVERTS – SCJ

Add G after code for Glassed - i.e: 723.300.100G

| Code         | Description          | A | B   | C   | D   |
|--------------|----------------------|---|-----|-----|-----|
| 723m.175.100 | Moulded              |   | 200 | 181 | 110 |
| 723.225.100  | Unglassed or Glassed |   | 250 | 150 | 110 |
| 723.300.100  | Unglassed or Glassed |   | 315 | 300 | 110 |
| 723.375.100  | Unglassed or Glassed |   | 400 | 345 | 110 |
| 723m.175.150 | Moulded              |   | 200 | 215 | 160 |
| 723m.225.150 | Moulded              |   | 250 | 261 | 160 |
| 723m.300.150 | Moulded              |   | 315 | 175 | 160 |
| 723.375.150  | Unglassed or Glassed |   | 400 | 420 | 160 |
| 723m.225.175 | Moulded              |   | 250 | 256 | 200 |
| 723m.300.175 | Moulded              |   | 315 | 320 | 200 |
| 723.375.175  | Unglassed or Glassed |   | 400 | 420 | 200 |
| 723m.300.225 | Moulded              |   | 315 | 298 | 250 |
| 723.375.225  | Unglassed or Glassed |   | 400 | 430 | 250 |
| 723m.375.300 | Moulded              |   | 400 | 367 | 315 |
| 723.475.100  | Unglassed or Glassed |   | 500 | 400 | 110 |
| 723.475.150  | Unglassed or Glassed |   | 500 | 400 | 160 |
| 723.475.175  | Unglassed or Glassed |   | 500 | 412 | 200 |
| 723.475.225  | Unglassed or Glassed |   | 500 | 432 | 250 |
| 723.475.300  | Unglassed or Glassed |   | 500 | 454 | 315 |
| 723.475.375  | Unglassed or Glassed |   | 500 | 473 | 400 |

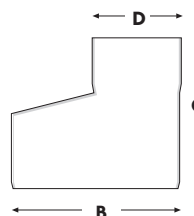

All level inverts are Male/Female.  
AS/NZS 1254:2010

## ADAPTORS – DOWNPIPE – SCJ

| Code                     | Description                                    | A      | B     | C   | D     |
|--------------------------|--|--------|-------|-----|-------|
| <b>763.100.50.100 RE</b> | 100mm x 50mm Downpipe to 100mm S/Water Adaptor | 100x50 | 110   | 200 |       |
| <b>763.100.80 RD</b>     | 80mm Downpipe to 100mm S/Water Adaptor         | 80     | 110   | 150 |       |
| <b>763.100.65 RD</b>     | 65mm Downpipe to 100mm S/Water Adaptor         | 65     | 110   | 170 |       |
| <b>762.100</b>           | 100mm Downpipe Riser                           | 138    | 110   | 224 |       |
| <b>762.100</b>           | 100mm Downpipe Riser – SCJ                     | 138    | 116   | 224 |       |
| <b>763.100.80</b>        | 80mm Downpipe to 100mm S/Water Reducing Bush   | 80     | 110   | 50  |       |
| <b>720.65.50</b>         | 65mm x 50mm Gutter Pipe Dropper                | 74x74  | 60x45 | 60  | 64x50 |
| <b>720.100.50</b>        | 100mm x 50mm Gutter Pipe Dropper               | 115x65 | 91x41 | 81  | 46x94 |
| <b>720.80</b>            | 80mm Gutter Pipe Dropper                       | 95     | 72    | 75  | 75    |
| <b>720.100</b>           | 100mm Gutter Pipe Dropper                      | 125    | 99    | 80  | 96    |
| <b>720.150</b>           | 150mm Gutter Pipe Dropper                      | 187    | 140   | 150 | 145   |
| <b>720.175</b>           | 175mm Gutter Pipe Dropper                      | 200    |       | 260 |       |
| <b>720.225</b>           | 225mm Gutter Pipe Dropper                      | 250    |       | 300 |       |

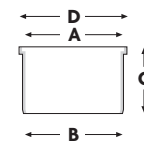
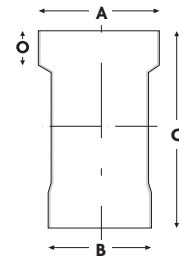
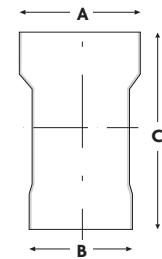

## KERB OUTLETS

| Code                           | Description             | A  | B      | C    | D   |
|--------------------------------|-------------------------|----|--------|------|-----|
| <b>765.110.HDPE</b>            | c/w PVC Adaptor         | 43 | 110    | 485  | 120 |
| <b>765m.100.PVC</b>            | PVC Kerb Outlet Moulded | 60 | 110    | 390  | 100 |
| <b>765.100.PVC.Adapt</b>       | PVC Kerb Adaptor        | 83 | 110    | 235  | 110 |
| <b>765.100.PVC.Auck</b>        | PVC Kerb Outlet         | 50 | 110    | 230  | 100 |
| <b>765.100.Pres</b>            | PVC Kerb Outlet         | 50 | 110    | 385  | 135 |
| <b>765.90.PVC</b>              | PVC Kerb Outlet         | 35 | 90     | 390  | 117 |
| <b>765.80.Pres</b>             | PVC Kerb Outlet         |    |        | 390  |     |
| <b>765L.100.PVC</b>            | PVC Long Kerb Outlet    | 66 | 110    | 1470 | 117 |
| <b>765E.100.PVC Extension</b>  | PVC Kerb Extension      | 66 | 120x70 | 1195 | 117 |
| <b>765L.110 HDPE Long</b>      | LDPE Long Kerb Outlet   | 54 | 110    | 1470 | 107 |
| <b>765E.110 HDPE Extension</b> | LDPE Kerb Extension     | 56 | 120x72 | 1415 | 102 |

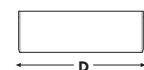

AS/NZS 1254:2010



## RAINHEADS



A = Length  
B = Width  
C = Height

| Code                   | Description                               | Outlet         | A   | B   | C   |
|------------------------|---|----------------|-----|-----|-----|
| <b>768.80/90</b>       | ½ Round – Round Outlet – White            | 80mm or 90mm   | 200 | 420 | 390 |
| <b>768C.80/90</b>      | ½ Round – Round Outlet – Coloured         | 80mm or 90mm   | 200 | 420 | 390 |
| <b>768.100x50</b>      | ½ Round – Rect Outlet – White             | 100mm x 50mm   | 160 | 420 | 390 |
| <b>768C.100x50</b>     | ½ Round – Rect Outlet – Coloured          | 100mm x 50mm   | 160 | 420 | 390 |
| <b>768.70</b>          | Square Small – Round Outlet – White       | 70mm           | 160 | 300 | 350 |
| <b>768C.70</b>         | Square Small – Round Outlet – Coloured    | 70mm           | 160 | 300 | 350 |
| <b>768.90</b>          | Square Small – Round Outlet – White       | 90mm           | 160 | 300 | 350 |
| <b>768C.90x45</b>      | Square small – Round Outlet – Coloured    | 90mm           | 160 | 300 | 350 |
| <b>768.80LH</b>        | Square Small – LHS Horizontal – White     | 80mm or 90mm   | 160 | 300 | 350 |
| <b>768C.80LH</b>       | Square Small – LHS Horizontal – Coloured  | 80mm or 90mm   | 160 | 300 | 350 |
| <b>768.80RH</b>        | Square Small – RHS Horizontal – White     | 80mm or 90mm   | 160 | 300 | 350 |
| <b>768C.80RH</b>       | Square small – RHS Horizontal – Coloured  | 80mm or 90mm   | 160 | 300 | 35  |
| <b>768.90x45</b>       | Square Small – Rect Outlet – White        | 90mm x 45mm    | 160 | 300 | 350 |
| <b>768C.90x45</b>      | Square Small – Rect Outlet – Coloured     | 90mm x 45mm    | 160 | 300 | 350 |
| <b>768.100/150</b>     | Square Large – Round Outlet – White       | 100mm x 150mm  | 200 | 400 | 350 |
| <b>768C.100/150</b>    | Square Large – Round Outlet – Coloured    | 100mm x 150mm  | 200 | 400 | 500 |
| <b>768.100x150</b>     | Square Large – Rect Outlet – White        | 100mm x 50mm   | 200 | 400 | 500 |
| <b>768C.100x150</b>    | Square Large – Rect Outlet – Coloured     | 100mm x 50mm   | 200 | 400 | 500 |
| <b>768.100/150XL</b>   | Square X Large – Round Outlet – White     | 100mm or 150mm | 210 | 600 | 420 |
| <b>768C.100/150XL</b>  | Square X Large – Round Outlet – Coloured  | 100mm or 150mm | 210 | 600 | 420 |
| <b>768.100/150XXL</b>  | Square XX Large – Round Outlet – White    | 100mm or 150mm | 340 | 600 | 580 |
| <b>768C.100/150XXL</b> | Square XX Large – Round Outlet – Coloured | 100mm or 150mm | 340 | 600 | 580 |

Made to Order Product

## MANHOLE – SHORT – PLAIN – RRJ

| Code                   | Description     | A    | B | C   | D |
|------------------------|-----------------|------|---|-----|---|
| <b>Z700PL.175.600</b>  | RRJ Plain Short | 600  |   | 200 |   |
| <b>Z700PL.225.600</b>  | RRJ Plain Short | 600  |   | 250 |   |
| <b>Z700PL.300.600</b>  | RRJ Plain Short | 600  |   | 315 |   |
| <b>Z700PL.175.1000</b> | RRJ Plain Short | 1000 |   | 200 |   |
| <b>Z700PL.225.1000</b> | RRJ Plain Short | 1000 |   | 250 |   |
| <b>Z700PL.300.1000</b> | RRJ Plain Short | 1000 |   | 315 |   |

Rubber rings included

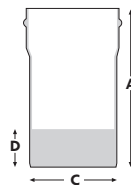
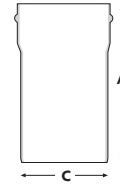

## MANHOLE – SHORT – GRITTED – RRJ

| Code                  | Description       | A   | B | C   | D   |
|-----------------------|-------------------|-----|---|-----|-----|
| <b>Z700GR.175.600</b> | RRJ Gritted Short | 600 |   | 200 | 200 |
| <b>Z700GR.225.600</b> | RRJ Gritted Short | 600 |   | 250 | 200 |
| <b>Z700GR.300.600</b> | RRJ Gritted Short | 600 |   | 315 | 250 |

Rubber rings included

AS/NZS 1254:2010