



SN16 INDEX

Bends – Plain – RRJ	5.1
Bends – Formed – RRJ	5.2
Junctions – Wye – RRJ	5.3
Junctions – Wye – Double RRJ	5.4
Junctions – Lunden – RRJ	5.5
Junctions – Lunden – Double RRJ	5.6
Manhole – Short – Plain – RRJ	5.7
Manhole – Short – Gritted – RRJ	5.7
Manhole – Hydro Connector – RRJ	5.8
Manhole – Connector – RRJ	5.8
Junction – Drop – RRJ	5.9
Coupling – Plain	5.9
Coupling – Slip	5.9

All rubber ring joint socket profiles are suitable only for use with fixed ring type "Anger Lock" rings.



BENDS – PLAIN – RRJ

CODE	DESCRIPTION	A	B	C	D
1571.150.11° (SN16)	Female/Male	500		160	
1571.150.22° (SN16)	Female/Male	500		160	
1571.150.45° (SN16)	Female/Male	500		160	
1571.150.88° (SN16)	Female/Male	500		160	
1571.175.11° (SN16)	Female/Male	500		200	
1571.175.22° (SN16)	Female/Male	500		200	
1571.175.45° (SN16)	Female/Male	500		200	
1571.175.88° (SN16)	Female/Male	500		200	
1571.225.11° (SN16)	Female/Male	650		250	
1571.225.22° (SN16)	Female/Male	650		250	
1571.225.45° (SN16)	Female/Male	650		250	
1571.225.88° (SN16)	Female/Male	650		250	
1571.300.11° (SN16)	Female/Male	700		315	
1571.300.22° (SN16)	Female/Male	700		315	
1571.300.45° (SN16)	Female/Male	700		315	
1571.300.88° (SN16)	Female/Male	700		315	
1571.375.11° (SN16)	Female/Male	800		400	
1571.375.22° (SN16)	Female/Male	800		400	
1571.375.45° (SN16)	Female/Male	800		400	
1571.375.88° (SN16)	Female/Male	800		400	
1571.475.11° (SN16)	Female/Male	1200		500	
1571.475.22° (SN16)	Female/Male	1200		500	
1571.475.45° (SN16)	Female/Male	1200		500	
1571.475.88° (SN16)	Female/Male	1200		500	

Rubber rings included
NB: All fittings are fibreglassed
AS/NZS 1260:2009

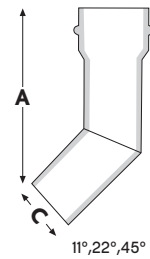
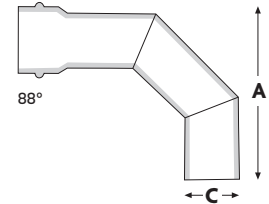



BENDS – FORMED – RRJ

1503F

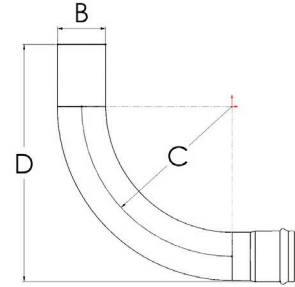

CODE	DESCRIPTION	A	B	C	D
1503F.100.11° (SN16)	Female/Male			110	300
1503F.100.22° (SN16)	Female/Male			110	300
1503F.100.45° (SN16)	Female/Male			110	300
1503F.100.90° (SN16)	Female/Male			110	300
1503F.150.11° (SN16)	Female/Male			160	500
1503F.150.22° (SN16)	Female/Male			160	500
1503F.150.45° (SN16)	Female/Male			160	500
1503F.150.90° (SN16)	Female/Male			160	500
1503F.175.11° (SN16)	Female/Male			200	
1503F.175.22° (SN16)	Female/Male			200	
1503F.175.45° (SN16)	Female/Male			200	
1503F.175.90° (SN16)	Female/Male			200	
1503F.225.11° (SN16)	Female/Male			250	650
1503F.225.22° (SN16)	Female/Male			250	650
1503F.225.45° (SN16)	Female/Male			250	650
1503F.225.90° (SN16)	Female/Male			250	650
1503F.300.11° (SN16)	Female/Male			315	
1503F.300.22° (SN16)	Female/Male			315	
1503F.300.45° (SN16)	Female/Male			315	
1503F.300.90° (SN16)	Female/Male			315	

Rubber rings included
 AS/NZS 1260:2009

SN16



JUNCTIONS – WYE – RRJ

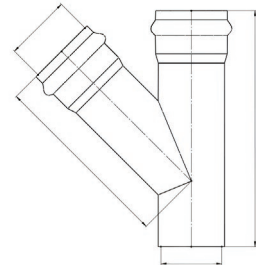

CODE	DESCRIPTION	A	B	C	D
1574.150.45° (SN16)	Female/Female/Male	700	160	160	455
1574.175.45° (SN16)	Female/Female/Male	800	200	200	
1574.225.45° (SN16)	Female/Female/Male	1000	250	250	765
1574.300.45° (SN16)	Female/Female/Male	1000	315	315	750
1574.375.45° (SN16)	Female/Female/Male		400	400	
1574.475.45° (SN16)	Female/Female/Male		500	500	250
1574.150.100.45° (SN16)	Female/Female/Male	600	110	160	250
1574.175.100.45° (SN16)	Female/Female/Male	600	110	200	250
1574.225.100.45° (SN16)	Female/Female/Male	650	110	250	400
1574.300.100.45° (SN16)	Female/Female/Male	750	110	315	475
1574.375.100.45° (SN16)	Female/Female/Male	750	110	400	550
1574.475.100.45° (SN16)	Female/Female/Male		110	500	475
1574.175.150.45° (SN16)	Female/Female/Male	750	160	200	425
1574.225.150.45° (SN16)	Female/Female/Male	750	160	250	475
1574.300.150.45° (SN16)	Female/Female/Male	800	160	315	670
1574.375.150.45° (SN16)	Female/Female/Male	850	160	400	700
1574.475.150.45° (SN16)	Female/Female/Male		160	500	690
1574.225.175.45° (SN16)	Female/Female/Male	800	200	250	540
1574.300.175.45° (SN16)	Female/Female/Male	1000	200	315	605
1574.375.175.45° (SN16)	Female/Female/Male	1000	200	400	690
1574.475.175.45° (SN16)	Female/Female/Male		200	500	
1574.300.225.45° (SN16)	Female/Female/Male	1000	250	315	670
1574.375.225.45° (SN16)	Female/Female/Male	1500	250	400	755
1574.475.225.45° (SN16)	Female/Female/Male		250	500	
1574.375.300.45° (SN16)	Female/Female/Male		315	400	
1574.475.300.45° (SN16)	Female/Female/Male		315	500	
1574.475.375.45° (SN16)	Female/Female/Male		400	500	
1584.150.100.45° (SN16)	Male/Male/Male		110	160	

375mm and 475mm fittings are a non-stock item and are therefore made to order and non-returnable

All fittings are fibreglassed

RRJ fittings are Female/Female/Male (mainway/branch/mainway)

Rubber rings included

AS/NZS 1260:2009



JUNCTIONS – WYE – DOUBLE RRJ

1504

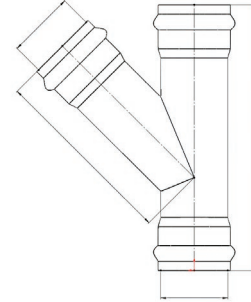

CODE	DESCRIPTION	A	B	C	D
1504.150.45° (SN16)	Female/Female/Female	700	160	160	455
1504.175.45° (SN16)	Female/Female/Female	800	200	200	
1504.225.45° (SN16)	Female/Female/Female	1000	250	250	765
1504.300.45° (SN16)	Female/Female/Female	1000	315	315	750
1504.375.45° (SN16)	Female/Female/Female		400	400	
1504.475.45° (SN16)	Female/Female/Female		500	500	
1504.150.100.45° (SN16)	Female/Female/Female	600	110	160	250
1504.175.100.45° (SN16)	Female/Female/Female	600	110	200	250
1504.225.100.45° (SN16)	Female/Female/Female	650	110	250	400
1504.300.100.45° (SN16)	Female/Female/Female	750	110	315	475
1504.375.100.45° (SN16)	Female/Female/Female	750	110	400	550
1504.475.100.45° (SN16)	Female/Female/Female		110	500	
1504.175.150.45° (SN16)	Female/Female/Female	750	160	200	425
1504.225.150.45° (SN16)	Female/Female/Female	750	160	250	475
1504.300.150.45° (SN16)	Female/Female/Female	800	160	315	670
1504.375.150.45° (SN16)	Female/Female/Female	850	160	400	700
1504.475.150.45° (SN16)	Female/Female/Female		160	500	
1504.225.175.45° (SN16)	Female/Female/Female	800	200	250	540
1504.300.175.45° (SN16)	Female/Female/Female	1000	200	315	605
1504.375.175.45° (SN16)	Female/Female/Female	1000	200	400	690
1504.475.175.45° (SN16)	Female/Female/Female		200	500	
1504.300.225.45° (SN16)	Female/Female/Female	1000	250	315	670
1504.375.225.45° (SN16)	Female/Female/Female	1500	250	400	755
1504.475.225.45° (SN16)	Female/Female/Female		250	500	
1504.375.300.45° (SN16)	Female/Female/Female		315	400	
1504.475.300.45° (SN16)	Female/Female/Female		315	500	
1504.475.375.45° (SN16)	Female/Female/Female		400	500	

375mm and 475mm fittings are a non-stock item and are therefore made to order and non-returnable

All fittings are fibreglassed

RRJ fittings are Female/Female/Female (mainway/branch/mainway)

Rubber rings included

AS/NZS 1260:2009

SN16



JUNCTIONS – LUNDEN – RRJ

CODE	DESCRIPTION	A	B	C	D
1574.150.88° (SN16)	Female/Female/Male	600	160	160	360
1574.175.88° (SN16)	Female/Female/Male	800	200	200	580
1574.225.88° (SN16)	Female/Female/Male	1000	250	250	648
1574.300.88° (SN16)	Female/Female/Male	1000	315	315	
1574.375.88° (SN16)	Female/Female/Male	1500	400	400	
1574.475.88° (SN16)	Female/Female/Male	2000	500	500	
1574M.150.100.88° (SN16)	Female/Female/Male	600	110	160	220
1574.175.100.88° (SN16)	Female/Female/Male	600	110	200	250
1574.225.100.88° (SN16)	Female/Female/Male	600	110	250	250
1574.300.100.88° (SN16)	Female/Female/Male	750	110	315	250
1574.375.100.88° (SN16)	Female/Female/Male	750	110	400	300
1574.475.100.88° (SN16)	Female/Female/Male		110	500	
1574.175.150.88° (SN16)	Female/Female/Male	650	160	200	385
1574.225.150.88° (SN16)	Female/Female/Male	750	160	250	410
1574.300.150.88° (SN16)	Female/Female/Male	800	160	315	440
1574.375.150.88° (SN16)	Female/Female/Male	1000	160	400	480
1574.475.150.88° (SN16)	Female/Female/Male		160	500	
1574.225.175.88° (SN16)	Female/Female/Male	800	200	250	605
1574.300.175.88° (SN16)	Female/Female/Male	1000	200	315	637
1574.375.175.88° (SN16)	Female/Female/Male	1200	200	400	680
1574.475.175.88° (SN16)	Female/Female/Male		200	500	
1574.300.225.88° (SN16)	Female/Female/Male	1000	250	315	680
1574.375.225.88° (SN16)	Female/Female/Male	1500	250	400	723
1574.475.225.88° (SN16)	Female/Female/Male		250	500	
1574.375.300.88° (SN16)	Female/Female/Male		315	400	
1574.475.300.88° (SN16)	Female/Female/Male		315	500	
1574.475.375.88° (SN16)	Female/Female/Male		400	500	
1584.150.100.88° (SN16)	Male/Male/Male		110	160	

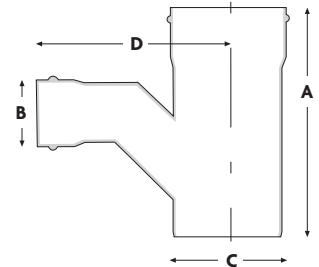

475mm fittings are also available on request
 375mm and 475mm fittings are a non-stock item and are therefore made to order and non-returnable
 All fittings are fibreglassed
 RRJ fittings are Female/Female/Male (mainway/branch/mainway)
 Rubber rings included
 AS/NZS 1260:2009



JUNCTIONS – LUNDEN – DOUBLE RRJ

1504

CODE	DESCRIPTION	A	B	C	D
1504.150.88° (SN16)	Female/Female/Female	600	160	160	360
1504.175.88° (SN16)	Female/Female/Female	800	200	200	580
1504.225.88° (SN16)	Female/Female/Female	1000	250	250	
1504.300.88° (SN16)	Female/Female/Female	1000	315	315	
1504.375.88° (SN16)	Female/Female/Female	1500	400	400	
1504.475.88° (SN16)	Female/Female/Female	2000	500	500	
1504M.150.100.88° (SN16)	Female/Female/Female	600	110	160	220
1504.175.100.88° (SN16)	Female/Female/Female	600	110	200	250
1504.225.100.88° (SN16)	Female/Female/Female	600	110	250	250
1504.300.100.88° (SN16)	Female/Female/Female	750	110	315	250
1504.375.100.88° (SN16)	Female/Female/Female	750	110	400	300
1504.475.100.88° (SN16)	Female/Female/Female		110	500	
1504.175.150.88° (SN16)	Female/Female/Female	650	160	200	385
1504.225.150.88° (SN16)	Female/Female/Female	750	160	250	410
1504.300.150.88° (SN16)	Female/Female/Female	800	160	315	440
1504.375.150.88° (SN16)	Female/Female/Female	1000	160	400	480
1504.475.150.88° (SN16)	Female/Female/Female		160	500	
1504.225.175.88° (SN16)	Female/Female/Female	800	200	250	605
1504.300.175.88° (SN16)	Female/Female/Female	1000	200	315	637
1504.375.175.88° (SN16)	Female/Female/Female	1200	200	400	680
1504.475.175.88° (SN16)	Female/Female/Female		200	500	
1504.300.225.88° (SN16)	Female/Female/Female	1000	250	315	
1504.375.225.88° (SN16)	Female/Female/Female	1500	250	400	
1504.475.225.88° (SN16)	Female/Female/Female		250	500	
1504.375.300.88° (SN16)	Female/Female/Female		315	400	
1504.475.300.88° (SN16)	Female/Female/Female		315	500	
1504.475.375.88° (SN16)	Female/Female/Female		400	500	

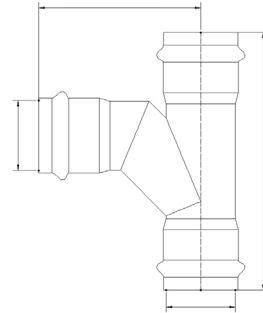

475mm fittings are also available on request
 375mm and 475mm fittings are a non-stock item and are therefore made to order and non-returnable
 All fittings are fibreglassed
 RRJ fittings are Female/Female/Female (mainway/branch/mainway)
 Rubber rings included
 AS/NZS 1260:2009

SN16



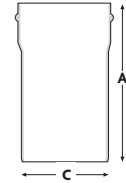

1500PL

MANHOLE – SHORT – PLAIN – RRJ

Add length to code - i.e: 1500PL.225.600 (SN16)

CODE		DESCRIPTION	A	B	C	D
1500PL.100 (SN16)	600	Ungritted Plain Short	600		110	
	1000	Ungritted Plain Short	1000		110	
1500PL.150 (SN16)	600	Ungritted Plain Short	600		160	
	1000	Ungritted Plain Short	1000		160	
1500PL.175 (SN16)	600	Ungritted Plain Short	600		200	
	1000	Ungritted Plain Short	1000		200	
1500PL.225 (SN16)	600	Ungritted Plain Short	650		250	
	1000	Ungritted Plain Short	1000		250	
1500PL.300 (SN16)	600	Ungritted Plain Short	650		315	
	1000	Ungritted Plain Short	1000		315	
1500PL.375 (SN16)	1000	Ungritted Plain Short	1000		400	
1500PL.475 (SN16)	1000	Ungritted Plain Short	1000		500	

1500GR

MANHOLE – SHORT – GRITTED – RRJ

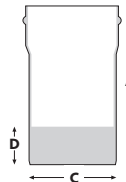

CODE		DESCRIPTION	A	B	C	D
1500GR.100 600 (SN16)		Gritted Manhole Short	600		100	200
1500GR.150 600 (SN16)		Gritted Manhole Short	600		160	200
1500GR.175 600 (SN16)		Gritted Manhole Short	600		200	200
1500GR.225 600 (SN16)		Gritted Manhole Short	650		250	220
1500GR.300 600 (SN16)		Gritted Manhole Short	650		315	250
1500GR.375 1000 (SN16)		Gritted Manhole Short	600		400	300
1500GR.475 1000 (SN16)		Gritted Manhole Short	1000		500	300



MANHOLE – HYDRO CONNECTOR – RRJ

1582

CODE	DESCRIPTION	A	B	C	D
1582.110	Gritted PVC – Hydrophilic Sealant	330	121	112	
1582.125	Gritted PVC – Hydrophilic Sealant	330	136	127	
1582.160	Gritted PVC – Hydrophilic Sealant	350	173	162	
1582.180	Gritted PVC – Hydrophilic Sealant	350	200	182	
1582.200	Gritted PVC – Hydrophilic Sealant	350	217	202	
1582.225	Gritted PVC – Hydrophilic Sealant	350	242	228	
1582.250	Gritted PVC – Hydrophilic Sealant	350	270	253	
1582.280	Gritted PVC – Hydrophilic Sealant	400	313	285	
1582.315	Gritted PVC – Hydrophilic Sealant	400	335	318	
1582.355	Gritted PVC – Hydrophilic Sealant	450	375	358	
1582.400	Gritted PVC – Hydrophilic Sealant	450	406	403	
1582.450	Gritted PVC – Hydrophilic Sealant	460	477	454	
1582.500	Gritted PVC – Hydrophilic Sealant	460	527	503	
1582.560	Gritted PVC – Hydrophilic Sealant	600	594	564	
1582.630	Gritted PVC – Hydrophilic Sealant	600	668	634	

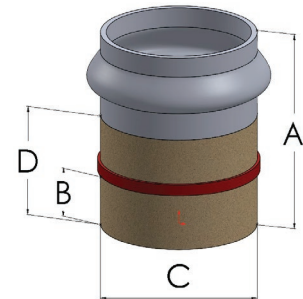

MANHOLE – CONNECTOR – RRJ

1580

CODE	DESCRIPTION	A	B	C	D
1580.100	Gritted Connector	265		132	
1580.150	Gritted Connector	285		180	
1580.175	Gritted Connector	230		245	
1580.225	Gritted Connector	220		300	
1580.300	Gritted Connector	300		365	
1580.375	Gritted Connector				

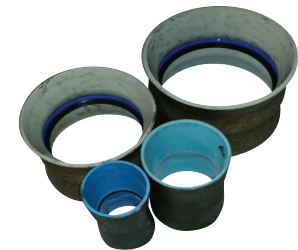

SN16





1506
1507

JUNCTION – DROP – RRJ

CODE	DESCRIPTION	A	B	C	D
1506.100 (SN16)	(Manukau City) Gritted	290		110	430
1506.150 (SN16)	(Manukau City) Gritted	350		160	550
1506.175 (SN16)	(Manukau City) Gritted				
1506.225 (SN16)	(Manukau City) Gritted				
1507.150 (SN16)	(Waitakere City) c/w Access Cap	410		160	610
1507.175 (SN16)	(Waitakere City) c/w Access Cap				
1507.225 (SN16)	(Waitakere City) c/w Access Cap				
1507.300 (SN16)	(Waitakere City) c/w Access Cap				

Rubber rings included
AS/NZS 1260:2009

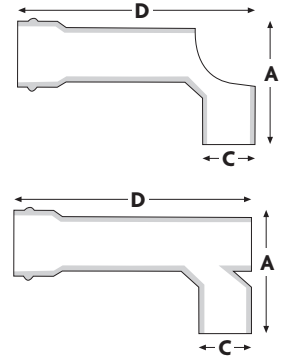

1510

COUPLING – PLAIN

CODE	DESCRIPTION	A	B	C	D
1510.L.150 (SN16)	Plain Coupling RRJ	400		160	
1510.L.175 (SN16)	Plain Coupling RRJ	445		200	
1510.L.225 (SN16)	Plain Coupling RRJ	450		250	
1510.L.300 (SN16)	Plain Coupling RRJ	650		315	
1510.L.375 (SN16)	Plain Coupling RRJ	700		400	

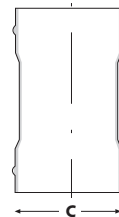

1511

COUPLING – SLIP

CODE	DESCRIPTION	A	B	C	D
1511.S.150 (SN16)	Slip Coupling RRJ	350		160	
1511.S.175 (SN16)	Slip Coupling RRJ	350		200	
1511.S.225 (SN16)	Slip Coupling RRJ	400		250	
1511.S.300 (SN16)	Slip Coupling RRJ	500		315	

